

SITE PLAN

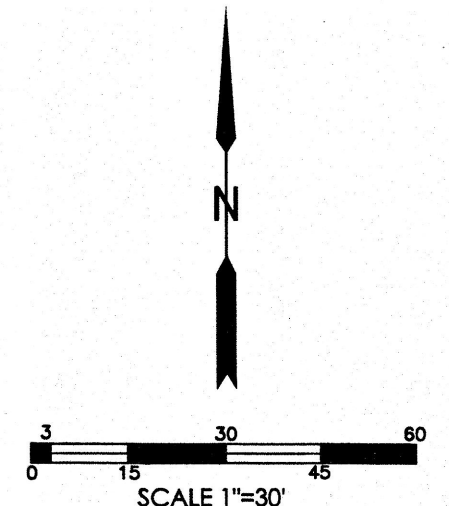
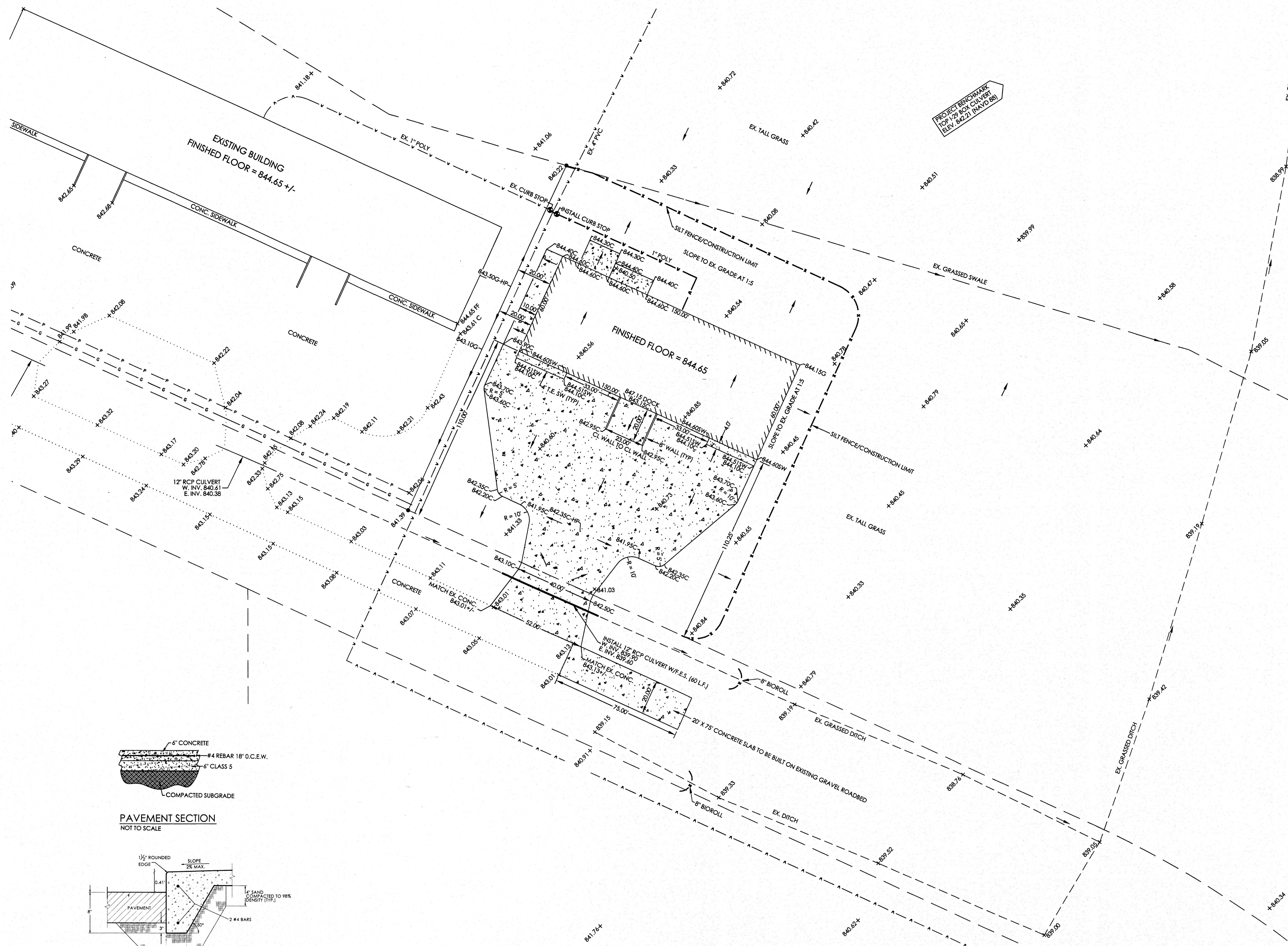

LEGEND

MONUMENT FOUND	●
SET MONUMENT	○
EXISTING PARCEL LINE	—
SECTION LINE	—
EASEMENT LINE	—
UNDERGROUND GAS	— G —
UNDERGROUND POWER	— P —
WATER LINE	— W —
GATE VALVE	⊙
TELEPHONE PEDISTAL	Δ

PLAN NOTES

- Contractor to verify size and elevation of all services with mechanical/owner prior to installation.
- All underground utility work shall be installed in accordance with the City of Grand Forks Standard Construction Specifications and standard details.
- Building will discharge sanitary waste to a septic tank and drain field system. Contractor to coordinate location of septic tank and drain field with owner prior to installation. Septic tank and drain field to be designed per North Dakota Department of Health requirements.
- Contractor shall maintain 8.0 foot minimum cover over water and sanitary sewer services.
- All utility locations shown on this plan are approximate. Contractor shall notify North Dakota One Call for locates (1-800-795-0555) 48 hours, 2 working days, not including holidays or weekends prior to any excavation on site.
- All pavement shall be 6" concrete w/ #4 rebar 18" O.C.E.W. on 6" Class 5 with compacted base.
- Proposed building will not utilize sump pumps.
- Slope in any handicap loading/unloading zones shall not exceed 2%. Cross slope on any handicap accessible routes shall not exceed 2%.
- Proposed building will be constructed without a basement.
- Erosion control measures shall be implemented in accordance with City of Grand Forks and North Dakota Department of Health requirements. This site will disturb less than 1 acre of land therefore a Storm Water Pollution Prevention Plan (SWPPP) permit is not required by the North Dakota Department of Health but has been developed for this site per City of Grand Forks requirements. The SWPP shall be fully implemented until the site has greater than 70% grass cover in disturbed areas. The erosion control devices shown on plan are considered minimum amount required for protection. The contractor shall place additional controls as required to control storm water or as required by City permitting requirements. Erosion control shall be installed to City of Grand Forks specifications and details.
- Contractor to provide construction entrances at ALL entrances and exits from construction site. Entrances shall be constructed to City of Grand Forks specifications. Construction exits shall be maintained in a manner to minimize the tracking of sediment onto paved surfaces.
- Contractor to connect corrugated pipe to roof drains and extend them to pavement or swales until grass has been established.
- Contractor to provide area for concrete truck washout. Washout area shall not be within 50 feet of ditch or swales.
- Contractor shall take care to leave as much grass area undisturbed as possible. All disturbed soil shall be reseeded and stabilized in a timely manner. The construction limits of this site shall be the location of the silt fence as shown on this plan.
- Erosion control to be removed only after site has been permanently stabilized.
- Contractor to protect stockpiles to prevent any sediment from leaving the site. Temporary stockpile shall not be placed in surface waters, stormwater conveyance systems, curb and gutter systems, conduits or ditches.

LAND DESCRIPTION

Lot 3, Block 1, Brown Corporation Second Addition, Grand Forks County, North Dakota.

STORMWATER DATA

Stormwater discharge from proposed warehouse site will be treated by grassed buffers and grassed swales prior to discharge to the legal drain located to the northeast of site. The area of the existing ditch and existing swale located behind and in front of proposed building will have adequate area to treat runoff. Filter design per Minnesota Stormwater Manual.

MINIMUM GRASSED BUFFER = 25 FT
DISTURBED LAND = 41,282 SQ. FT. ± 0.95 AC. ± 0.00149 SQ. MILES
TOTAL PROPOSED IMPERVIOUS = 23,025 SQ. FT.
TYPE II RAINFALL DISTRIBUTION
SOIL = TYPE C (NRCS SOIL SURVEY)
K = 0.2" / HR = 4.8" / DAY ± 0.4" / DAY
ASSUMED FILTER DEPTH = 1.5'
DRAWDOWN TIME = 2 DAYS
HEIGHT OF WATER ABOVE FILTER BED = 0.25 FT
Q100, existing = 6.13 CFS
Q100, proposed = 7.89 CFS
Q100, existing / Q100, proposed = 0.777
Vs / Vt = 0.19
RUNOFF = 4.77 IN
RUNOFF VOLUME = 0.376 AC-FT
STORAGE VOLUME REQUIRED = 0.071 AC-FT = 3,111 CU. FT.
AREA GRASSED SWALE NEEDED TO TREAT VOLUME = 3,333 SQ. FT.

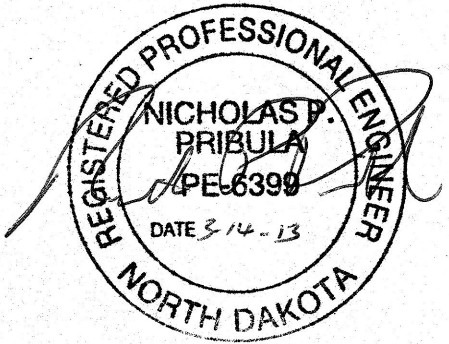

APPROVAL: _____
APPROVED BY: _____
TITLE: _____
DATE: _____

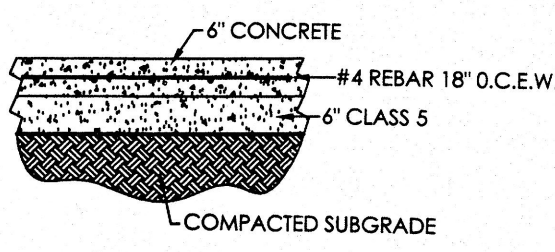

PAVEMENT SECTION
NOT TO SCALE

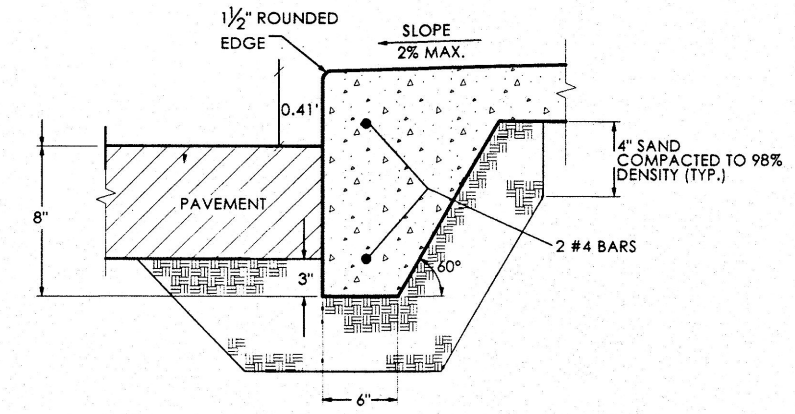

THICKENED EDGE WALK
NOT TO SCALE

BROWN CORPORATIONS PT LT 3, BLK 1, BROWN CORPORATION SECOND ADDITION	REVISED:	DRAWN BY: NP
REQUESTED BY: LEIF LARSEN - BROWN CORPORATIONS PO BOX 13458 GRAND FORKS, ND 58208-3458	DATE: 3-14-2013	SCALE: 1" = 60'
PRIBULA ENGINEERING 208 3RD AVENUE NW EAST GRAND FORKS, MN 56721	701-772-7058	DRAWING NO. 13-0314 PAGE NO. 1