

REFERENCE NOTES:

- 1 DIRECTIONAL BORE REQUIRED OUT TO SANITARY MAIN.
- 2 LOW SPOT OF EXISTING SURFACE GRADE, PROVIDE MINIMUM OF 6"-0" CLEAR COVER AT THIS LOCATION.
- 3 VERIFY LOCATION AND ELEVATION OF EXISTING SERVICE, SEE GENERAL NOTES.
- 4 TAPPING VALVE
- 5 VERIFY INVERT AND REPORT TO ENGINEER IMMEDIATELY
- 6 OPTIONAL SANITARY LINE ROUTE IF THE VERIFIED INVERTS ALLOW

GENERAL NOTES:

1. ALL WORK PERFORMED WITHIN THE PUBLIC RIGHT-OF-WAY SHALL BE DONE IN ACCORDANCE WITH THE CITY OF GRAND FORKS STANDARD CONSTRUCTION SPECIFICATIONS. PRIOR TO DOING ANY WORK IN THE CITY RIGHT-OF-WAY THE CONTRACTOR SHALL CALL THE ENGINEERING DEPARTMENT AT 746-2640.
2. ALL DRIVEWAYS LEADING TO REFUSE CONTAINERS SHALL BE CONSTRUCTED OF 6" CONCRETE WITH A MINIMUM 6" COMPACTED BASE.
3. ALL LANDSCAPING SHALL BE PROTECTED FROM VEHICULAR TRAFFIC BY A STANDARD CONCRETE CURB AND GUTTER.
4. ALL SIGNS TO BE APPROVED BY THE GRAND FORKS INSPECTIONS DEPARTMENT (CONVENTIONAL ZONING) OR PLANNING DEPARTMENT (PLANNED UNIT DEVELOPMENT.)
5. VERIFY POTENTIAL EXISTING SANITARY SERVICE AS SOON AS POSSIBLE, AND BEFORE STARTING ANY INTERIOR OR EXTERIOR SANITARY DRAIN PIPING.
6. ALL ROAD CLOSURE SIGNAGE AND BARRICADES SHALL BEET NDDOT OR CITY STANDARDS, SUBMIT A ROAD CLOSURE PLAN.
7. RESTORE EXISTING ASPHALT PAVEMENT WITH 5" OF NDDOT CLASS 27 OVER 8" OF AGGREGATE BASE.
8. CONNECT NEW SANITARY SERVICE INTO THE UPPER THIRD OF THE EXISTING MAIN PIPE.
9. RESTORE BELMONT ROAD PAVEMENT AS PER CITY SPECIFICATIONS.

SITE INFORMATION:

ZONING DISTRICT R4
 TOTAL SITE AREA: 44,500 SF
 EXISTING BUILDING: 22,150 SF
 NEW ADDITION: 450 SF
 NO EASEMENT RESTRICTIONS
 % IMPERVIOUS (BEFORE) 93.2%
 % IMPERVIOUS (AFTER) 93.2%
 NO CHANGE IN IMPERVIOUS SURFACE

PROJECT INFORMATION:

PROJECT NAME: ST. MARY'S CATHOLIC CHURCH ELEVATOR & LOBBY EXPANSION
 PROJECT ADDRESS: 216 BELMONT ROAD, GRAND FORKS, ND 58201
 ARCHITECT: EAPC
 CONTACT: RANDIE KLING
 PHONE: 701-775-3032
 EMAIL: rking@eapc.net

LEGEND:

- EX-W --- EXISTING WATER
- EX-SS --- EXISTING SANITARY SEWER
- SS --- NEW SANITARY SEWER
- EX-SD --- EXISTING STORM SEWER
- EXISTING CHAIN LINK FENCE
- PROPERTY LINES
- DRAINAGE ROUTE
- EXISTING WATER VALVE
- EXISTING FIRE HYDRANT
- EXISTING STORM DRAIN MANHOLE
- DETOUR TRAFFIC ROUTE
- EXISTING SANITARY SEWER MANHOLE
- EXISTING TREE
- EXISTING CATCH BASIN



Architecture Engineering Industrial
 Wind Energy Interior Design Construction

TELE 701.775.3000 FAX 701.772.3605
 3100 DeMers Avenue, Grand Forks ND 58201

Grand Forks ND Williston ND Bemidji MN
 Fargo ND Minot ND Bismarck ND
 Norwich VT

www.eapc.net



CLIENT

ST. MARY'S CATHOLIC CHURCH

PROJECT DESCRIPTION

ELEVATOR & LOBBY EXPANSION

CITY GRAND FORKS

STATE NORTH DAKOTA

ISSUE DATES

CD	CONSTRUCTION DOCUMENTS	16 Aug 2013
MARK	DESCRIPTION	DATE

PROJECT NO: 20123770
 DRAWN BY: RGH
 CHECKED BY: JRK

COPYRIGHT:
 All plans, specifications, computer files, field data, notes and other documents and instruments prepared by EAPC as instruments of service shall remain the property of EAPC. EAPC shall retain all common law, statutory and other reserved rights, including the copyright therein.

DRAWING TITLE
SITE PLAN

C100

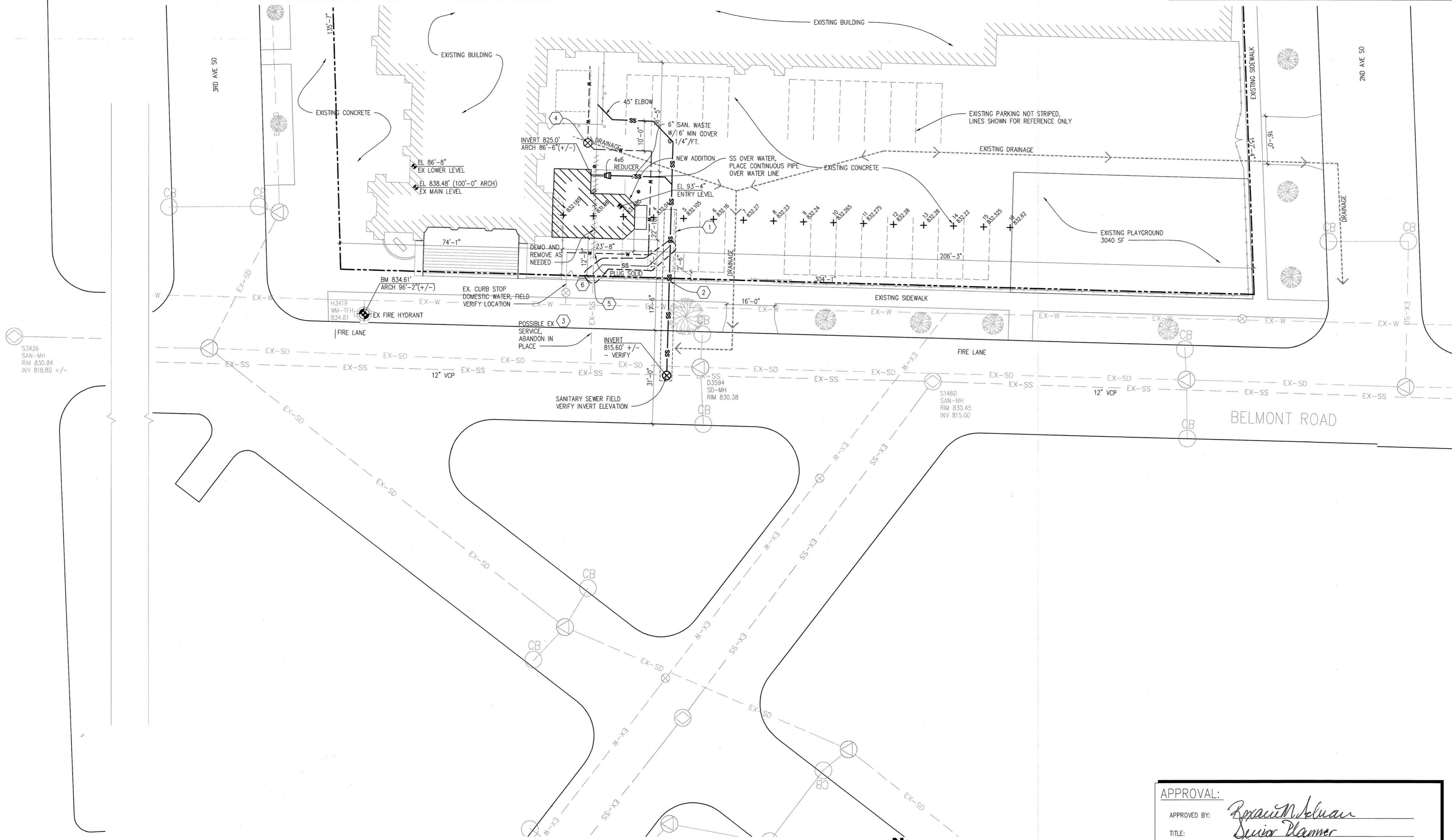

1 SITE PLAN
 C100 1/16" = 1'-0"

APPROVAL:
 APPROVED BY: *Randie Kling*
 TITLE: Senior Planner
 DATE: 8/16/2013